

SITE PLAN AT HOLDING NO. 43, BANER PARA,  
 MOUZA - SONARPUR, J.L. NO. 30, WARD NO. 13, P.D.  
 KULIAH-1493, 1494, 1495, 1496, 1497, 1498, 1499, 1500, 1501, 1502, 1503, 1504, 1505, 1506, 1507, 1508  
 DARI NO. 37, 39, 40, 41, 42, P.D. - SONARPUR (UHC II)  
 RAPUR BOHARPUR MUNICIPALITY HARIHARI, CHGT.,  
 24, PARAGHAT (SOUTH)

AREA OF LAND (AS PER DEED) :- 3743.81 SQM.  
 AREA OF LAND (AS PER PHYSICAL) :- 3743.26 SQM.  
 SCALE - 1:500  
 BOUNDARY DEMARCATED BY RED LINE

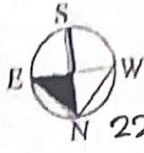

$22^{\circ}26'39''N$

$88^{\circ}25'23''E$

$22^{\circ}26'39''N$

$88^{\circ}25'25''E$

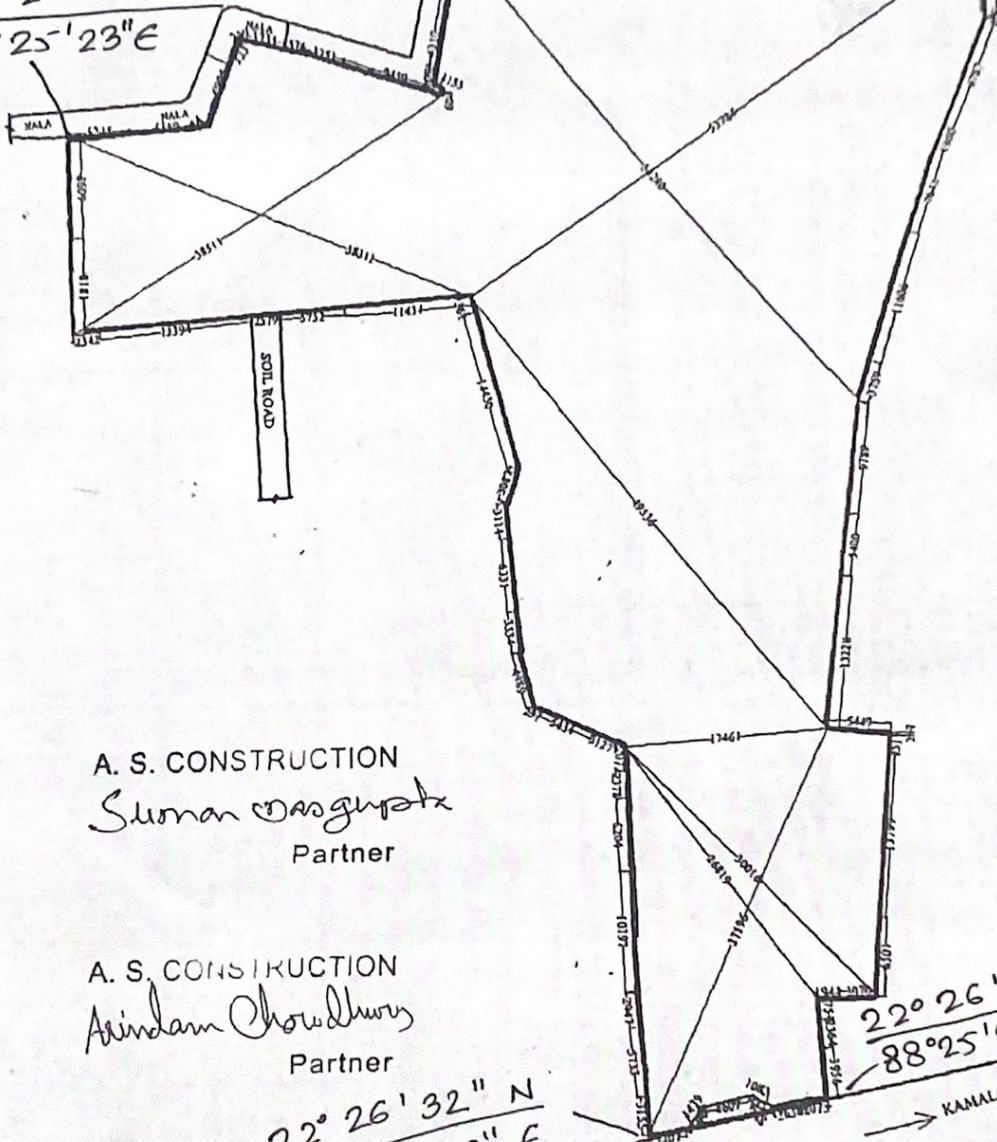

A. S. CONSTRUCTION  
*Suman Dasgupta*  
 Partner

A. S. CONSTRUCTION  
*Aindam Chowdhury*  
 Partner

$22^{\circ}26'32''N$   
 $88^{\circ}25'22''E$

$22^{\circ}26'32''N$   
 $88^{\circ}25'22''E$

